

- CONSTRUCTION SEQUENCE PHASE 1 - STORM DRAINS (FRONT STREET TO SUSQUEHANNA AVE) - 6 WORKWEEKS**
- COVER EXISTING INLET AT STA. 0+24, 13.5' RT AND EXISTING INLET AT STA. 2+35, 13.0' RT ALONG ELM STREET.
  - COVER EXISTING INLET AT STA. 4+71, 10.5' LT AND ADDITIONAL UPSTREAM INLET(S) ALONG FRONT STREET.
  - CONSTRUCT MH-D AND LAY THE CONNECTING DRAINAGE PIPES SPANNING ELM STREET (TEMPORARY CONNECTIONS WITH EXISTING UPSTREAM DRAINAGE SYSTEM). LAY THE CONNECTING DRAINAGE PIPE (MH-D TO I-120) SPANNING ELM STREET.
  - CONSTRUCT INLET I-120 AND LAY THE CONNECTING DRAINAGE PIPE (I-120 TO I-C) ALONG FRONT STREET.
  - CONSTRUCT INLET I-C AND ESTABLISH EXISTING UPSTREAM DRAINAGE PIPE INTO I-C. UNCOVER EXISTING UPSTREAM INLET(S) ALONG FRONT STREET.
  - CONSTRUCT INLET I-119 AND ESTABLISH PROPOSED DRAINAGE PIPE (MH-D TO I-119). LAY THE CONNECTING DRAINAGE PIPE ALONG ELM STREET (TEMPORARY CONNECTION WITH EXISTING UPSTREAM DRAINAGE SYSTEM). LAY THE CONNECTING DRAINAGE PIPE (I-119 TO I-121) SPANNING FRONT STREET.
  - CONSTRUCT INLET I-121.
  - CONSTRUCT INLET I-118 AND ESTABLISH PROPOSED DRAINAGE PIPE (I-119 TO I-118). LAY THE CONNECTING DRAINAGE PIPE ALONG ELM STREET (TEMPORARY CONNECTION WITH EXISTING UPSTREAM DRAINAGE SYSTEM). LAY THE CONNECTING DRAINAGE PIPE (I-118 TO I-117) SPANNING ELM STREET.
  - CONSTRUCT INLET I-117.
  - CONSTRUCT INLET I-116 AND ESTABLISH PROPOSED DRAINAGE PIPE (I-118 TO I-116). LAY THE CONNECTING DRAINAGE PIPE ALONG ELM STREET (TEMPORARY CONNECTION WITH EXISTING UPSTREAM DRAINAGE SYSTEM). LAY THE CONNECTING DRAINAGE PIPE (I-116 TO I-115) SPANNING ELM STREET.
  - CONSTRUCTION INLET I-115.
  - CONSTRUCT INLET I-114 AND ESTABLISH PROPOSED DRAINAGE PIPE (I-116 TO I-114). LAY THE CONNECTING DRAINAGE PIPE ALONG ELM STREET (TEMPORARY CONNECTION WITH EXISTING UPSTREAM DRAINAGE SYSTEM). LAY THE CONNECTING DRAINAGE PIPE (I-114 TO I-113) SPANNING ELM STREET.
  - COVER EXISTING INLETS AT STA. 4+85, 13.5' RT AND STA. 5+69, 14.0' RT ALONG ELM STREET.
  - CONSTRUCT INLET I-112 AND ESTABLISH PROPOSED DRAINAGE PIPE (I-114 TO I-112). LAY THE CONNECTING DRAINAGE PIPE ALONG ELM STREET (TEMPORARY CONNECTION WITH EXISTING UPSTREAM DRAINAGE SYSTEM). LAY THE CONNECTING DRAINAGE PIPE (I-112 TO I-111) SPANNING ELM STREET AND LAY THE CONNECTION DRAINAGE PIPE (I-112 TO I-109) SPANNING ELM STREET.
  - CONSTRUCT INLET I-109 AND LAY THE CONNECTING DRAINAGE PIPE (I-109 TO I-108).
  - CONSTRUCT INLET I-108.
  - CONSTRUCT INLET I-111 AND LAY THE CONNECTING DRAINAGE PIPE (I-111 TO I-110).
  - CONSTRUCT INLET I-110.

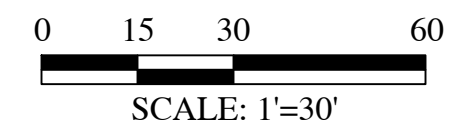
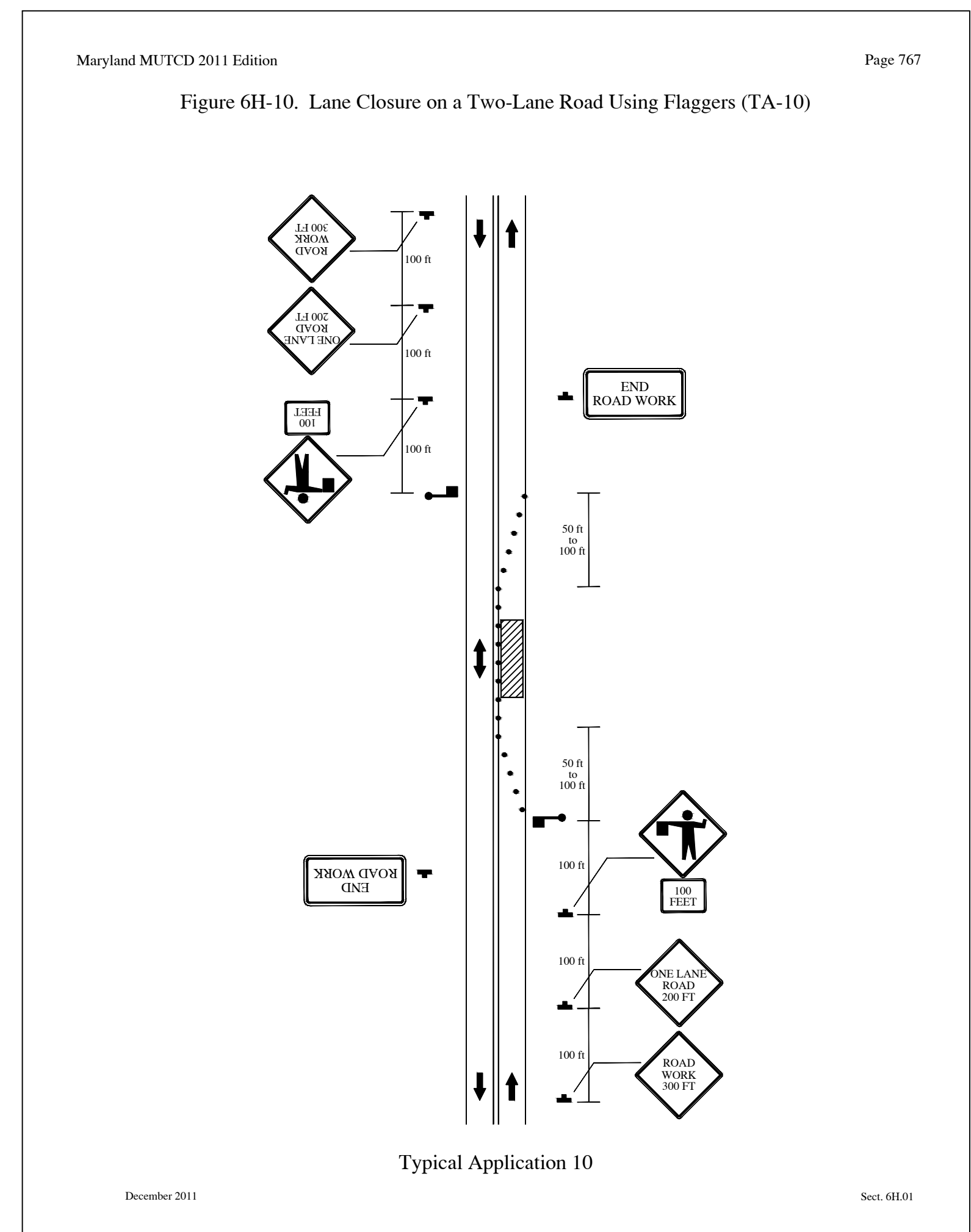

REVISIONS	DATE
CECIL COUNTY & S.C.D. COMMENTS	6-24-15
STORM DRAIN MODIFICATIONS	9-25-15

I, RALPH J. RYAN JR. P.E., HEREBY CERTIFY THAT THESE DOCUMENTS WERE PREPARED AND APPROVED BY ME AND THAT I AM A DULY LICENSED PROFESSIONAL ENGINEER UNDER THE LAWS OF THE STATE OF MARYLAND, LICENSE NO. 36237, EXPIRATION DATE 8-21-2016.

TOWN ENGINEER \_\_\_\_\_ DATE \_\_\_\_\_

APPROVED BY \_\_\_\_\_

SCALE 1"=30'

DESIGNED RJR

DRAWN RJR

CHECKED RJR

DATE 9-25-15

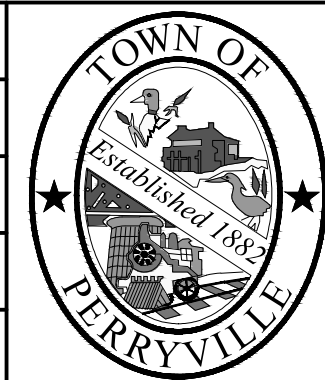

**THE TOWN OF PERRYVILLE**  
**CECIL COUNTY, MARYLAND**  
 515 BROAD STREET, PERRYVILLE, MD 21903  
 TOWN HALL 410-642-6066, TOWN ENGINEER 410-642-6068

Figure 6H-10. Lane Closure on a Two-Lane Road Using Flaggers (TA-10)

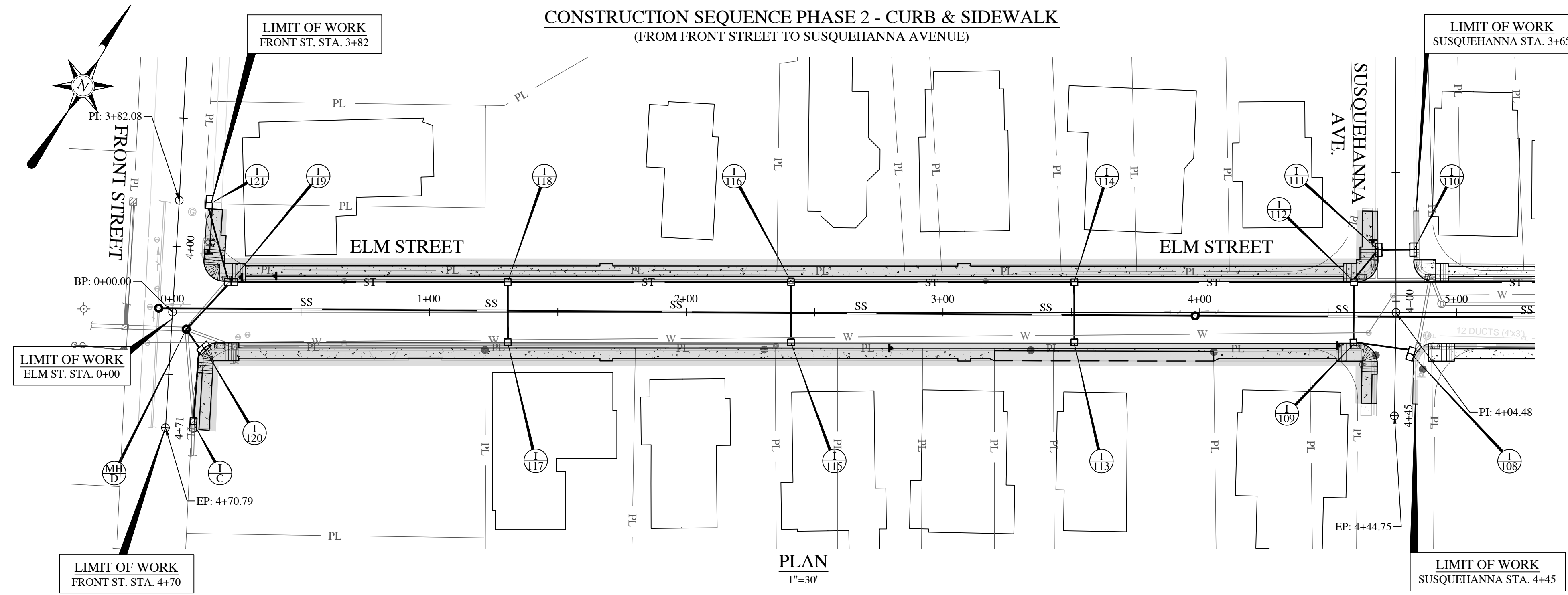

- CONSTRUCTION SEQUENCE PHASE 2 - CURB & SIDEWALK (FRONT STREET TO SUSQUEHANNA AVE) - 4 WORKWEEKS**
- CONSTRUCT PROPOSED CURB ALONG THE NORTH SIDE OF ELM STREET FROM THE INTERSECTION OF FRONT STREET TO THE INTERSECTION OF SUSQUEHANNA AVE.
  - CONSTRUCT SIDEWALK ALONG THE NORTH SIDE OF ELM STREET FROM THE INTERSECTION OF FRONT STREET TO THE INTERSECTION OF SUSQUEHANNA AVE. LAY 4 INCHES OF TOPSOIL OUT FROM SIDEWALK AS NECESSARY. SEED AND MULCH.
  - CONSTRUCT PROPOSED CURB ALONG THE SOUTH SIDE OF ELM STREET FROM THE INTERSECTION OF FRONT STREET TO THE INTERSECTION OF SUSQUEHANNA AVE.
  - CONSTRUCT SIDEWALK ALONG THE SOUTH SIDE OF ELM STREET FROM THE INTERSECTION OF FRONT STREET TO THE INTERSECTION OF SUSQUEHANNA AVE. LAY 4 INCHES OF TOPSOIL OUT FROM SIDEWALK AS NECESSARY. SEED AND MULCH.

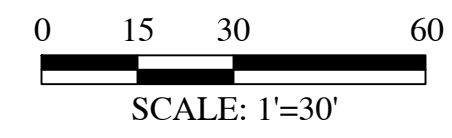

REVISIONS	DATE
CECIL COUNTY & S.C.D. COMMENTS	6-24-15
STORM DRAIN MODIFICATIONS	9-25-15

I, RALPH J. RYAN JR. P.E., HEREBY CERTIFY THAT THESE DOCUMENTS WERE PREPARED AND APPROVED BY ME AND THAT I AM A DULY LICENSED PROFESSIONAL ENGINEER UNDER THE LAWS OF THE STATE OF MARYLAND, LICENSE NO. 36237, EXPIRATION DATE 8-21-2016.

TOWN ENGINEER \_\_\_\_\_ DATE \_\_\_\_\_

APPROVED BY \_\_\_\_\_

SCALE	1"=30'
DESIGNED	RJR
DRAWN	RJR
CHECKED	RJR
DATE	9-25-15

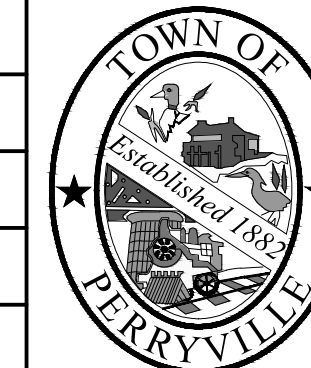

**THE TOWN OF PERRYVILLE**  
**CECIL COUNTY, MARYLAND**  
 515 BROAD STREET, PERRYVILLE, MD 21903  
 TOWN HALL 410-642-6066, TOWN ENGINEER 410-642-6068

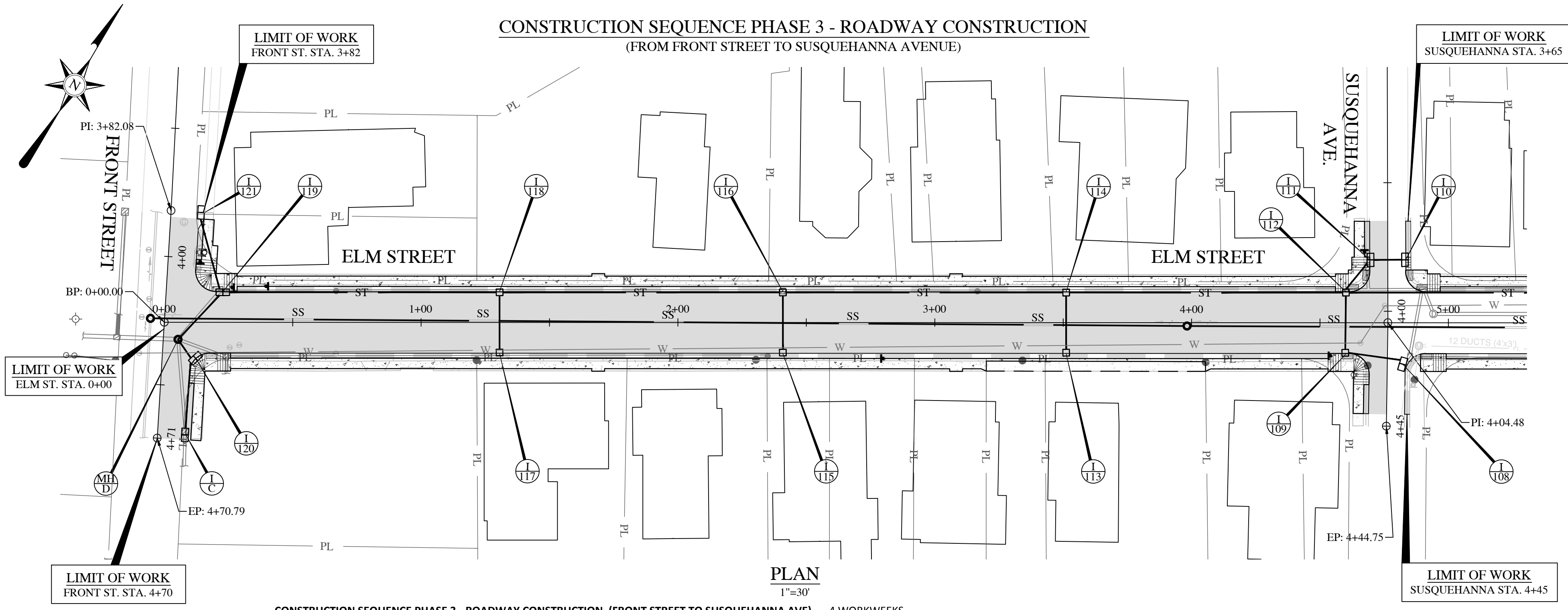

**CONSTRUCTION SEQUENCE PHASE 3 - ROADWAY CONSTRUCTION (FRONT STREET TO SUSQUEHANNA AVE) - 4 WORKWEEKS**

- LAY THE PROPOSED SUB-BASE GRADED AGGREGATE ALONG THE NORTH SIDE OF ELM STREET FROM THE INTERSECTION OF FRONT STREET TO THE INTERSECTION OF SUSQUEHANNA AVE.
- LAY THE PROPOSED BASE COURSE LEVEL USING 2 LIFTS ALONG THE NORTH SIDE OF ELM STREET FROM THE INTERSECTION OF FRONT STREET TO THE INTERSECTION OF SUSQUEHANNA AVE.
- LAY THE PROPOSED SUB-BASE GRADED AGGREGATE ALONG THE SOUTH SIDE OF ELM STREET FROM THE INTERSECTION OF FRONT STREET TO THE INTERSECTION OF SUSQUEHANNA AVE.
- LAY THE PROPOSED BASE COURSE LEVEL USING 2 LIFTS ALONG SOUTH SIDE OF ELM STREET FROM THE INTERSECTION OF FRONT STREET TO THE INTERSECTION OF SUSQUEHANNA AVE.

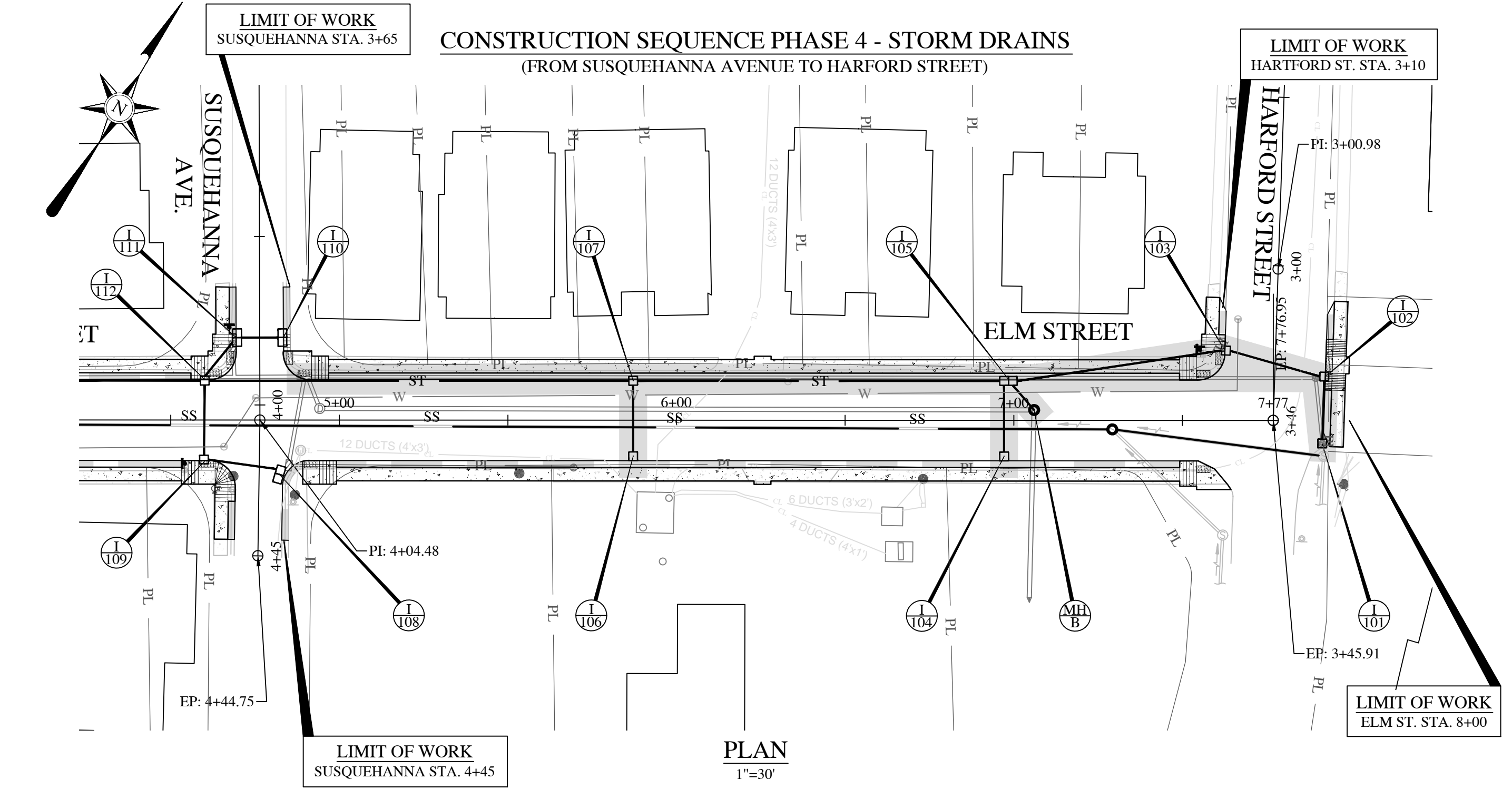

**CONSTRUCTION SEQUENCE PHASE 4 - STORM DRAINS (SUSQUEHANNA AVE TO HARTFORD STREET) - 3 WORKWEEKS**

- CONSTRUCT INLET I-107 AND ESTABLISH PROPOSED DRAINAGE PIPE (I-112 TO I-107). LAY THE CONNECTING DRAINAGE PIPE ALONG ELM STREET (TEMPORARY CONNECTION WITH EXISTING UPSTREAM DRAINAGE SYSTEM). LAY THE CONNECTING DRAINAGE PIPE (I-107 TO I-106) SPANNING ELM STREET.
- CONSTRUCT INLET I-106.
- COVER EXISTING INLETS AT STA. 7+89, 12.5' LT AND EXISTING INLET AT STA. 7+91, 7.0' RT ALONG ELM STREET.
- CONSTRUCT INLET I-105 AND ESTABLISH PROPOSED DRAINAGE PIPE (I-107 TO I-105). LAY THE CONNECTING DRAINAGE PIPE ALONG ELM STREET (TEMPORARY CONNECTION WITH EXISTING UPSTREAM DRAINAGE SYSTEM). LAY THE CONNECTING DRAINAGE PIPE (I-105 TO MH-B) SPANNING ELM STREET AND LAY THE CONNECTION DRAINAGE PIPE (I-105 TO I-104) SPANNING ELM STREET.
- CONSTRUCT MH-B AND ESTABLISH EXISTING UPSTREAM DRAINAGE PIPE INTO MH-B.
- CONSTRUCT INLET I-104.
- CONSTRUCT INLET I-103 AND ESTABLISH PROPOSED DRAINAGE PIPE (I-105 TO I-103). LAY THE CONNECTING DRAINAGE PIPE ALONG ELM STREET (TEMPORARY CONNECTION WITH EXISTING UPSTREAM DRAINAGE SYSTEM).
- CONSTRUCT INLET I-102 AND ESTABLISH PROPOSED DRAINAGE PIPE (I-103 TO I-102). LAY THE CONNECTION DRAINAGE PIPE SPANNING ELM STREET (TEMPORARY CONNECTION WITH EXISTING UPSTREAM DRAINAGE SYSTEM).
- CONSTRUCT INLET I-101.

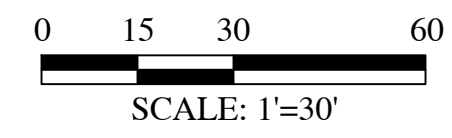

REVISIONS	DATE
CECIL COUNTY & S.C.D. COMMENTS	6-24-15
STORM DRAIN MODIFICATIONS	9-25-15

I, RALPH J. RYAN JR. P.E., HEREBY CERTIFY THAT THESE DOCUMENTS WERE PREPARED AND APPROVED BY ME AND THAT I AM A DULY LICENSED PROFESSIONAL ENGINEER UNDER THE LAWS OF THE STATE OF MARYLAND, LICENSE NO. 36237, EXPIRATION DATE 8-21-2016.

TOWN ENGINEER \_\_\_\_\_ DATE \_\_\_\_\_

APPROVED BY \_\_\_\_\_

SCALE: 1"=30'

DESIGNED: RJR

DRAWN: RJR

CHECKED: RJR

DATE: 9-25-15

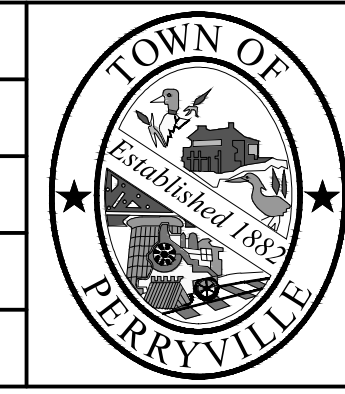

**THE TOWN OF PERRYVILLE**  
**CECIL COUNTY, MARYLAND**  
 515 BROAD STREET, PERRYVILLE, MD 21903  
 TOWN HALL 410-642-6066, TOWN ENGINEER 410-642-6068

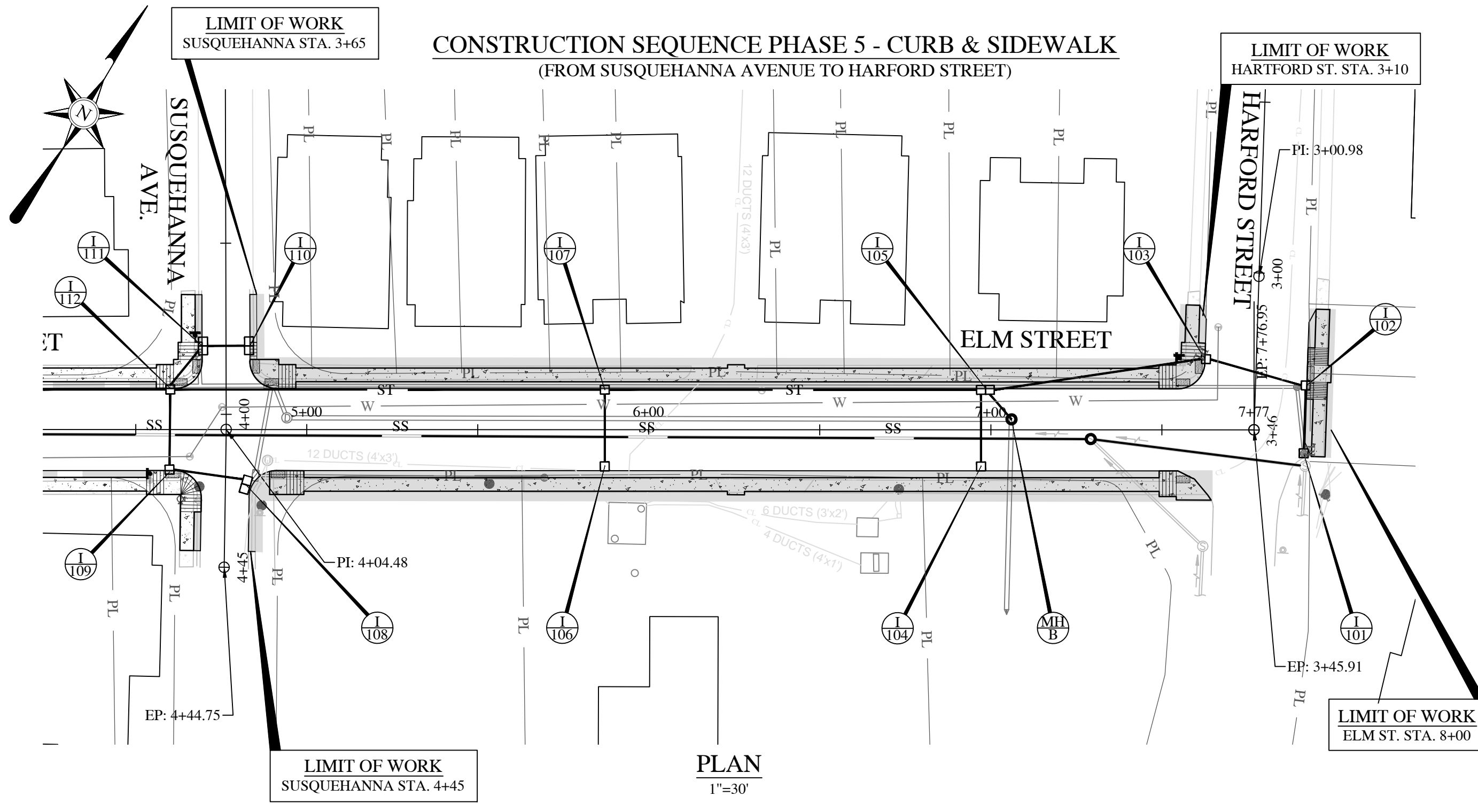

- CONSTRUCTION SEQUENCE PHASE 5 - CURB AND SIDEWALK (SUSQUEHANNA AVE TO HARTFORD STREET) - 2 WORKWEEKS**
- a. CONSTRUCT PROPOSED CURB ALONG THE NORTH SIDE OF ELM STREET FROM THE INTERSECTION OF SUSQUEHANNA AVE TO ELM STREET MID-BLOCK.
  - b. CONSTRUCT SIDEWALK ALONG THE NORTH SIDE OF ELM STREET FROM THE INTERSECTION OF SUSQUEHANNA AVE TO ELM STREET MID-BLOCK. LAY 4 INCHES OF TOPSOIL OUT FROM SIDEWALK AS NECESSARY. SEED AND MULCH.
  - c. CONSTRUCT PROPOSED CURB ALONG THE SOUTH SIDE OF ELM STREET FROM THE INTERSECTION OF SUSQUEHANNA AVE TO ELM STREET MID-BLOCK.
  - d. CONSTRUCT SIDEWALK ALONG THE SOUTH SIDE OF ELM STREET FROM THE INTERSECTION OF SUSQUEHANNA AVE TO ELM STREET MID-BLOCK. LAY 4 INCHES OF TOPSOIL OUT FROM SIDEWALK AS NECESSARY. SEED AND MULCH.

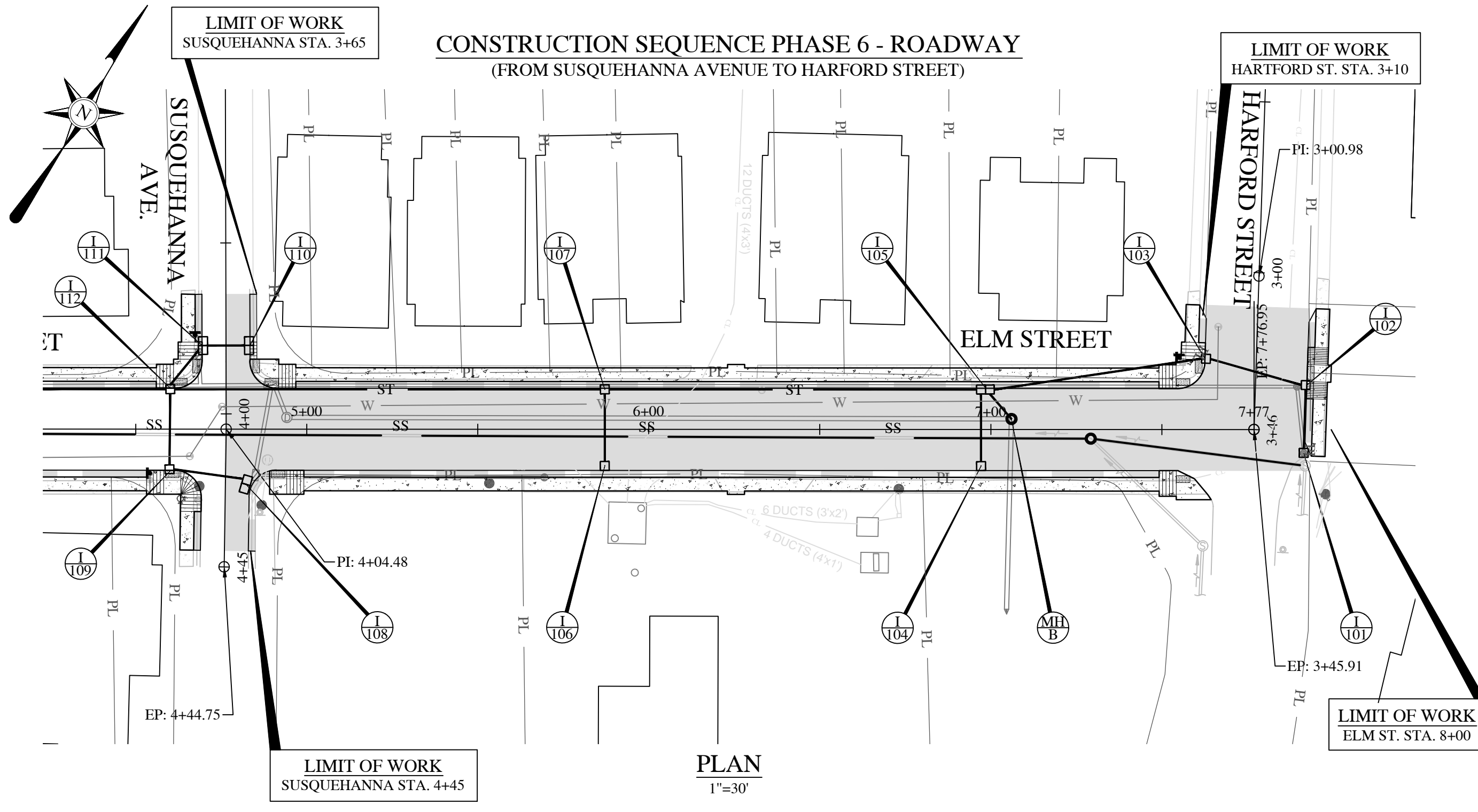

- CONSTRUCTION SEQUENCE PHASE 6 - ROADWAY CONSTRUCTION (SUSQUEHANNA AVE TO HARTFORD STREET) - 2 WORKWEEKS**
- a. LAY THE PROPOSED SUB-BASE GRADED AGGREGATE ALONG THE NORTH SIDE OF ELM STREET FROM THE INTERSECTION OF SUSQUEHANNA AVE TO ELM STREET MID-BLOCK.
  - b. LAY THE PROPOSED BASE COURSE LEVEL USING 2 LIFTS ALONG THE NORTH SIDE OF ELM STREET FROM THE INTERSECTION OF SUSQUEHANNA AVE TO ELM STREET MID-BLOCK.
  - c. LAY THE PROPOSED SUB-BASE GRADED AGGREGATE ALONG THE NORTH SIDE OF ELM STREET FROM THE INTERSECTION OF SUSQUEHANNA AVE TO ELM STREET MID-BLOCK.
  - d. LAY THE PROPOSED BASE COURSE LEVEL USING 2 LIFTS ALONG THE NORTH SIDE OF ELM STREET FROM THE INTERSECTION OF SUSQUEHANNA AVE TO ELM STREET MID-BLOCK.

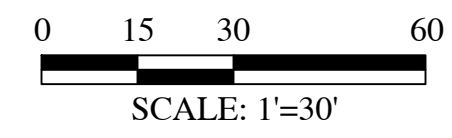

REVISIONS	DATE
CECIL COUNTY & S.C.D. COMMENTS	6-24-15
STORM DRAIN MODIFICATIONS	9-25-15

I, RALPH J. RYAN JR. P.E., HEREBY CERTIFY THAT THESE DOCUMENTS WERE PREPARED AND APPROVED BY ME AND THAT I AM A DULY LICENSED PROFESSIONAL ENGINEER UNDER THE LAWS OF THE STATE OF MARYLAND, LICENSE NO. 36237, EXPIRATION DATE 8-21-2016.

TOWN ENGINEER \_\_\_\_\_ DATE \_\_\_\_\_

APPROVED BY \_\_\_\_\_

SCALE: 1"=30'

DESIGNED: RJR

DRAWN: RJR

CHECKED: RJR

DATE: 9-25-15

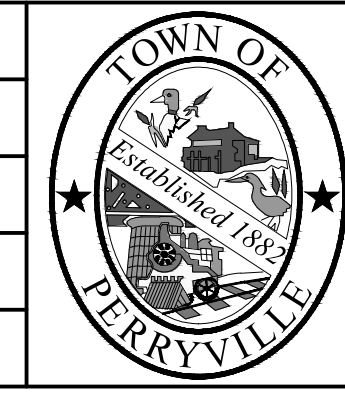

**THE TOWN OF PERRYVILLE**  
**CECIL COUNTY, MARYLAND**  
 515 BROAD STREET, PERRYVILLE, MD 21903  
 TOWN HALL 410-642-6066, TOWN ENGINEER 410-642-6068

**CONSTRUCTION SEQUENCE PHASE 7 - PAVING SURFACE COURSE**  
(FROM FRONT STREET TO HARFORD STREET)

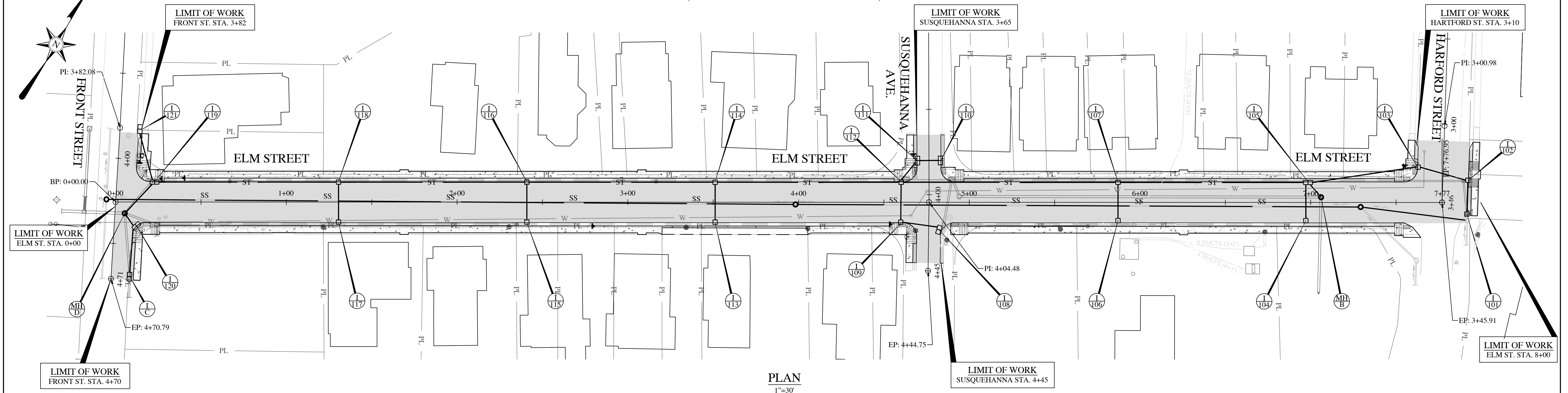

**PLAN**  
1"=30'

**CONSTRUCTION SEQUENCE PHASE 7 - PAVING SURFACE COURSE (FRONT STREET TO HARFORD STREET) - 2 WORKWEEKS**  
 a. LAY THE PROPOSED SURFACE COURSE LEVEL ALONG THE NORTH SIDE OF ELM STREET FROM THE INTERSECTION OF FRONT STREET TO THE INTERSECTION OF HARFORD STREET.  
 b. LAY THE PROPOSED SURFACE COURSE LEVEL ALONG THE SOUTH SIDE OF ELM STREET FROM THE INTERSECTION OF FRONT STREET TO THE INTERSECTION OF HARFORD STREET.

MAINTAINANCE OF TRAFFIC PLAN

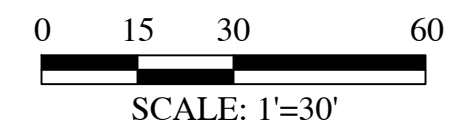

REVISIONS	DATE
CECIL COUNTY & S.C.D. COMMENTS	6-24-15
STORM DRAIN MODIFICATIONS	9-25-15

I, RALPH J. RYAN JR. P.E., HEREBY CERTIFY THAT THESE DOCUMENTS WERE PREPARED AND APPROVED BY ME AND THAT I AM A DULY LICENSED PROFESSIONAL ENGINEER UNDER THE LAWS OF THE STATE OF MARYLAND, LICENSE NO. 36237, EXPIRATION DATE 8-21-2016.

TOWN ENGINEER \_\_\_\_\_ DATE \_\_\_\_\_

APPROVED BY \_\_\_\_\_

SCALE 1"=30'  
 DESIGNED RJR  
 DRAWN RJR  
 CHECKED RJR  
 DATE 9-25-15

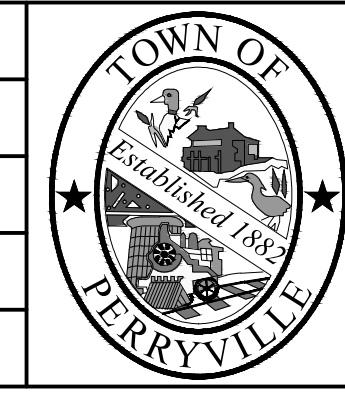

**THE TOWN OF PERRYVILLE**  
**CECIL COUNTY, MARYLAND**  
 515 BROAD STREET, PERRYVILLE, MD 21903  
 TOWN HALL 410-642-6066, TOWN ENGINEER 410-642-6068

DRAWING: \_\_\_\_\_ SHEET: \_\_\_\_\_ 28 OF 30